

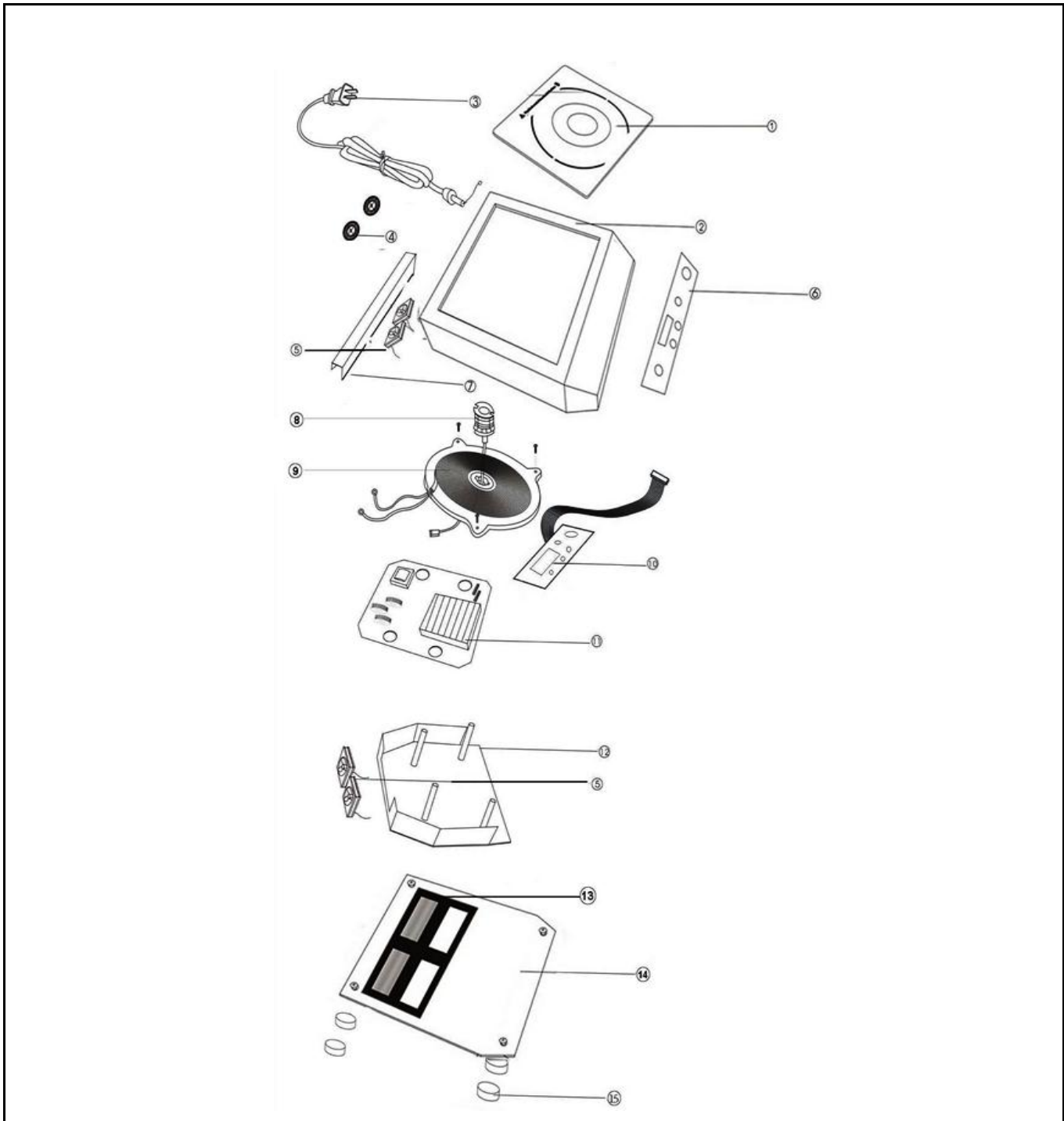

Drawing

 <b>Hendi B.V.</b> Steenoven 21 3911 TX Rhenen The Netherlands	<b>Batch #</b>	<b>Appliance part#</b>
	902691 and up	<b>239711</b>
	<b>Description</b>	
	Induction cooker 3500W	

<b>Date</b>	30-10-2012	<b>Revision #</b>	Revision version 1.2
<b>Revision</b>	Newer version main pcb and control pcb		



### Bill of materials (BOM)

 <b>Hendi B.V.</b> Steenoven 21 3911 TX Rhenen The Netherlands	<b>Batch #</b>	<b>Appliance part#</b>
	902691 and up	<b>239711</b>
	<b>Description</b>	
<b>Induction cooker 3500W</b>		

<b>Date</b>	30-10-2012	<b>Revision #</b>	Revision version 1.2
<b>Revision</b>	Newer version main pcb and control pcb		

Item	Description	Part#	Quantity	Remark	Picture
1	Glass plate	nss	1	Available as 901342	
2	Upper housing	901342	1	Incl item 1	
3	Power cord	929353	1		
4	Cover fan	n/a	2		
5	Fan 18V	901441	4		
6	Display sticker	901397	1		
7	Bracket	n/a	1		
8	Sensor	929742	1		
9	Main coil	901380	1		
10	Control pcb	901267	1		
11	Main pcb	901250	1		
12	Plastic bracket	n/a	1		
13	Filter	929759	1		
14	Bottom cover	n/a	1		
15	Feet	901373	4		

n/a -> not available

nss -> not sold separately

## Wiring diagram

 <b>Hendi B.V.</b> Steenoven 21 3911 TX Rhenen The Netherlands	<b>Batch #</b>	<b>Appliance part#</b>
	902691 and up	<b>239711</b>
	<b>Description</b>	
	Induction cooker 3500W	

<b>Date</b>	30-10-2012	<b>Revision #</b>	Revision version 1.2
<b>Revision</b>	Newer version main pcb and control pcb		

